

WAFER TYPE BUTTERFLY VALVE JIS 10K FLANGED

Model : ARV-812WT(J)

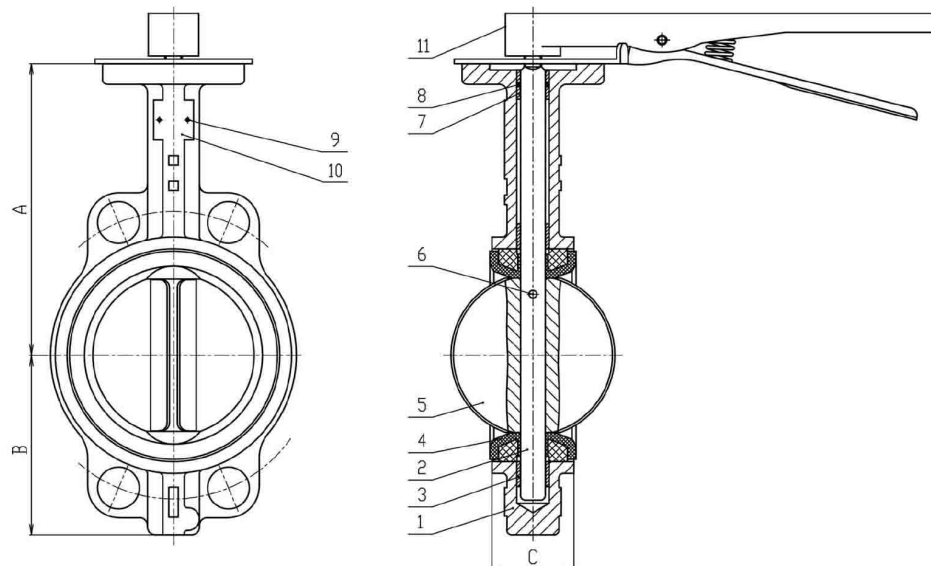

Design Standard

Flange Connection	JIS 10K
-------------------	---------

Hydrostatic Test

Working Pressure	1.0 Mpa
Shell Test Pressure	1.5 Mpa
Seal Test Pressure	1.1 Mpa
Suitable Temperature	-5 to 80 °C (NBR)

Material

No	PART	MATERIAL
1	BODY	CAST IRON
2	SHAFT	SS 420
3	BUSHING (LONG)	PTFE
4	SEAT	NBR
5	DISC	CF8
6	PIN	SS 316
7	BUSHING (SHORT)	PTFE
8	O-RING	NBR
9	RIVET	ALUMINIUM
10	NAME PLATE	ALUMINIUM
11	HANDLE LEVER	DI

Dimension in mm

SIZES	DN	A	B	C	Torque (Nm)	Weight (kg)
2"	50	156	80	42.04	14	2.4
2.1/2"	65	162	89	44.68	15	2.76
3"	80	170	95	45.21	22	3.2
4"	100	185	114	52.07	37	4.54
5"	125	207	127	54.36	58	6.5
6"	150	216	139	55.75	94	7.78
8"	200	256	175	60.58	174	13.4
10"	250	248	203	65.63	286	19.7
12"	300	280	242	76.9	429	28.7

The contents of this literature are for informative purposes only. Arita is not responsible for suitability or compatibility of these products in relation to system requirement. For specific requirements, consult Arita or its distributors. Arita reserves the right to change or modify product design without prior notice.

WAFER TYPE BUTTERFLY VALVE JIS 10K FLANGED

Model : ARV-812WT(J)

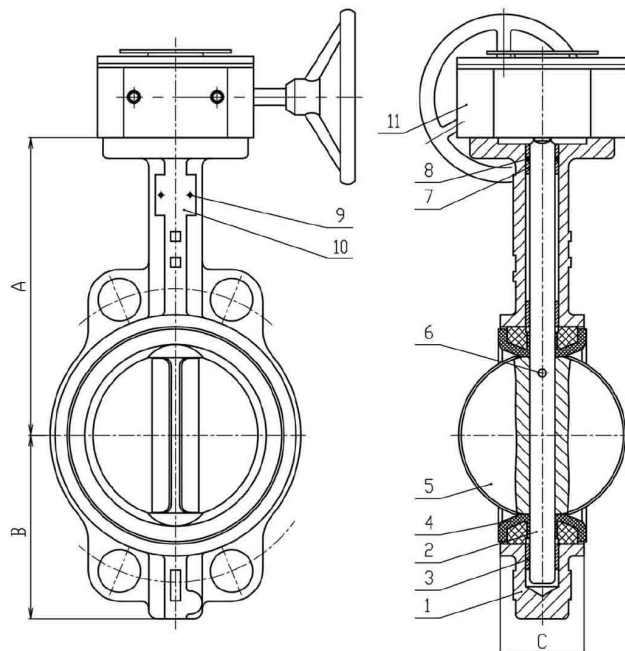

Design Standard

Flange Connection	JIS 10K
-------------------	---------

Hydrostatic Test

Working Pressure	1.0 Mpa
Shell Test Pressure	1.5 Mpa
Seal Test Pressure	1.1 Mpa
Suitable Temperature	-5 to 80 °C (NBR)

Material

No	PART	MATERIAL
1	BODY	CAST IRON
2	SHAFT	SS 420
3	BUSHING (LONG)	PTFE
4	SEAT	NBR
5	DISC	CF8
6	PIN	SS 316
7	BUSHING (SHORT)	PTFE
8	O-RING	NBR
9	RIVET	ALUMINIUM
10	NAME PLATE	ALUMINIUM
11	GEAR BOX	

Dimension in mm

SIZES	DN	A	B	C	Torque (Nm)	Weight (kg)
2"	50	156	80	42.04	14	6.08
2.1/2"	65	162	89	44.68	15	6.48
3"	80	170	95	45.21	22	6.88
4"	100	185	114	52.07	37	7.54
5"	125	207	127	54.36	58	9.5
6"	150	216	139	55.75	94	10.6
8"	200	256	175	60.58	174	19
10"	250	248	203	65.63	286	25.3
12"	300	280	242	76.9	429	36