



UNIMECH GROUP, MALAYSIA



A MEMBER OF UNIMECH GROUP, MALAYSIA

## AIR VENT VALVE

Model : ARV-811SE

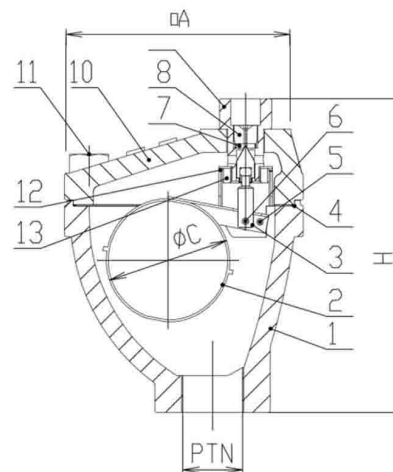

### Capacity Curve

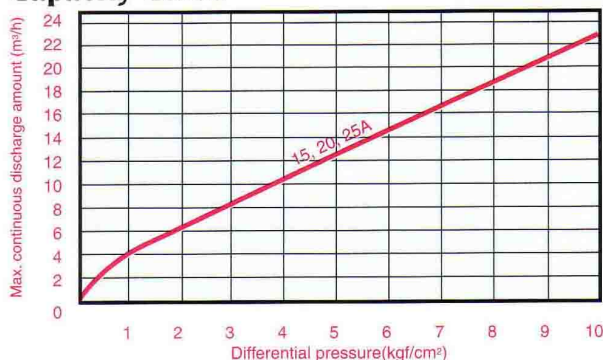

### Specification

Applicable Fluid	Cold or hot water and oil
Fluid Specific Gravity	0.85 or more
Applicable Temperature	5 ~ 80°C
Applicable Pressure	Max. 10 kgf/cm²
End Connection	Screwed BSPT
Hydraulic Pressure Test	15 kgf/cm² (Body)
	11 kgf/cm² (Seat)

### Material

No	PART	MATERIAL
1	BODY	FC 200
2	FLOAT	SS 304
3	NEEDLE	BRASS / SUS 304
4	'O' RING	NBR
5	BRACKET PIN	SUS 304
6	NEEDLE PIN	SUS 304
7	ORIFICE	NBR
8	NIPPLE NUT	BRASS
9	NIPPLE	BRASS
10	CAP	FC 200
11	BOLT	MILD STEEL
12	BRACKET	SUS 304
13	JAM NUT	BRASS

### Dimension in mm

SIZES	DN	PTN	A	H	ØC	Weight (KG)
1/2"	15	1/2"	120	155	60	3.2
3/4"	20	3/4"	120	155	60	3.4
1"	25	1"	120	155	60	3.6

The contents of this literature are for informative purposes only. Arita is not responsible for suitability or compatibility of these products in relation to system requirement. For specific requirements, consult Arita or its distributors. Arita reserves the right to change or modify product design without prior notice.

Our Ref. :ARTAV1- 07/23