



UNIMECH GROUP, MALAYSIA



A MEMBER OF UNIMECH GROUP, MALAYSIA

HIGH PRESSURE BALL VALVE SCREWED END

Technical Data

Features :

- High Pressure Capabilities
- Viton Static Seals
- Machined Delrin Seats
- Hard Chrome Plated Steel Balls
- Connection : NPT Thread
- Block Body Type : 6 - 25mm
- Forged Body Type : 32 - 50mm

Material

No	PART	MATERIAL
1	BODY	NICKEL PLATED CARBON STEEL
2	BALL	CARBON STEEL
3	STEM	CARBON STEEL
4	LEVER	ZINC PLATED (for size 6 - 15mm) CARBON STEEL (for size 20 - 50mm)
5	BALL SEAT	DELTRIN (POM)
6	O-RING	FKM (VITON)

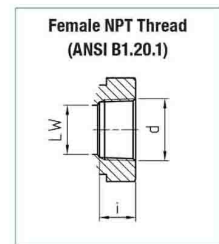
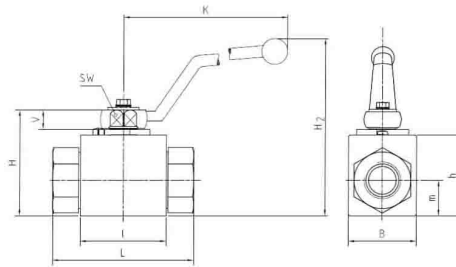

Dimension in mm (Block Body Type)

DN	LW	L	I	B	H	h	m	V	SW	K	i	H2	Pressure (bar)
6	6	69	40	26	47	33	13.5	11	9	115	13.7	82	500
10	10	72	43	32	52	38	17.5	11	9	115	13.5	87	500
15	13	83	48	35	54	40	19	11	9	115	17	89	500
20	20	95	62	49	75	57	24.5	14	14	170	18.3	126	420
25	25	120	66	58	83	65	29.5	14	14	170	22.1	134	315

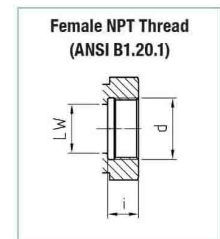
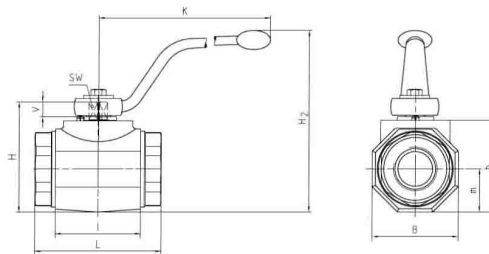

Dimension in mm (Forged Body Type)

DN	LW	L	I	B	H	h	m	V	SW	K	i	H2	Pressure (bar)
32	32	111	80	81	107	86	40.5	16.5	17	306	22	171	420
40	38	130	85	100	124	103	50	16.5	17	306	24	188	420
50	48	140	100	118	138	117	59	16.5	17	306	26	202	420

The contents of this literature are for informative purposes only. Unimech is not responsible for suitability or compatibility of these products in relation to system requirement. For specific requirements, consult Unimech or its distributors. Unimech reserves the right to change or modify product design without prior notice.