

UNIJIN® LOW PRESSURE GAUGE

Model : P421

P421 models are designed for non-corrosive environment with extremely sensitive and accurate. The brass chamber element is designed to measure low pressure, compound and vacuum for gaseous and dry air media. P421 model is complete with external zero adjustment screw at its back case for easy re-calibration when necessary.



Standard Specification

Dial Size

63mm(2.5");75mm(3")

Scale Range (mbar, mmH₂O)

0 ~ 6000 mmH₂O

Working Pressure

75% of Full Scale

Zero Adjustment

At Back Case (75mm)
Inside window (63mm)

Accuracy

63mm(± 2.5%); 75mm(± 2.5%) of Full Scale

Working Temperature

Ambient : -20 ~ 60°C
Process : -20 ~ 60°C

Material

Case & Cover : Chrome Plated Brass
Window : Glass (75mm); Acrylic(snap-on)(63mm)
Movement : Brass
Element : Brass
Capsule Type : Brass
Connection : Chrome Plated Brass

Pressure Gauge Ordering Information

Model

P421

Mounting Type

A: Direct bottom connection

Dial Size

63mm; 75mm

Scale Range refer table

Connection Type

1/4"; 3/8" BSPT

Example of Order

Model
P421

Mounting Type
(A)

Dial Size
75mm

Scale Range
0 ~ 300mbar

Connection
3/8" BSPT

Basic Dimensions

CODE A

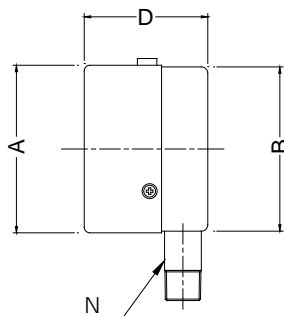
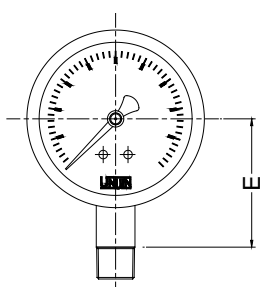

A: Direct bottom connection

Unit : mm

	ø 63	ø 75
A	67.0	78.5
B	66.0	76.5
D	47.0	57.0
E	42.0	55.0
N	14.0	17.0