

## MULTI-JET ROTARY VANE WHEEL DRY-DIAL TYPE COLD WATER METER (BSP THREAD)



This range of water meter is used to measure the total quantity of cold potable water which consumed in household or resident unit passing through the pipeline.

Compliance with Standard : Technical data conforms to ISO 4064 Class B Standard for Horizontal installation.

### Product Features :

- Multi-jet, Rotaryvane wheel type.
- Dry-dial, Magnetic drive, Resistance to exterior magnet interference.
- Selected high quality materials for steady, reliable characteristic & good looking.
- Vacuum sealed register ensures the dial kept free from fog and keep the reading clear in a long term service.
- Measuring accuracy conform to ISO 4064 Class B Standard.
- Universal use. Easy for interchange & maintenance.
- Iron body, cold water meter, remote reading transmission system and anti-theft device, the pulse constant : 10L/Pulse, 100L/Pulse, 1000L/Pulse for option.

### Installation Requirements :

1. The meter should be installed in horizontal position with the register face upwards.
2. Pipeline must be flushed before installation.
3. The meter should be constantly full of water during operation.

# MULTI-JET ROTARY VANE WHEEL DRY-DIAL TYPE COLD WATER METER (BSP THREAD)

### WORKING CONDITIONS

Water Temperature :  $0^{\circ}\text{C} \leq t \leq 40^{\circ}\text{C}$

Water Pressure :  $\leq 1.0 \text{ Mpa}$

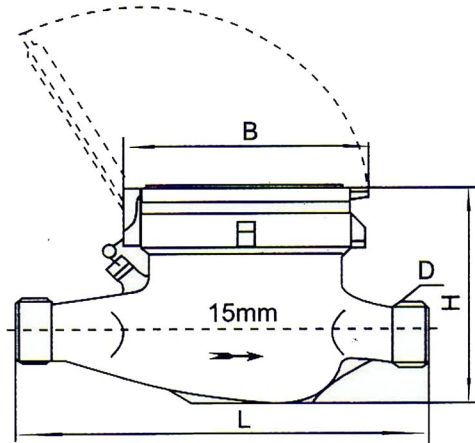

### Dimensions (mm)

Size	L	B	H	D	Weight (kg)
15	165/190	99	104	G3/4B	1.5/1.6
20	190/195	99	106	G 1B	1.7/1.8
25	260/225	104	120	G1-1/4B	2.4/2.6
32	260/230	104	120	G1-1/2B	2.7/2.8
40	300/245	125	155	G 2B	4.5/5.4
50	300	125	155	G2-1/2B	7.2

### Technical Data

Size (mm)	Class	Qs Overload Flow	Qp Nominal Flow	Qt Transitional Flow	Qmin Min Flow	Starting Flow	Min Reading	Max Reading
		m <sup>3</sup> /h		L/h				
15	B	3	1.5	120	30	14	0.0001	99999
20	B	5	2.5	200	50	16	0.0001	99999
25	B	7	3.5	280	70	19	0.0001	99999
32	B	12	6.0	480	120	25	0.0001	99999
40	B	20	10	800	200	56	0.0001	99999
50	B	30	15	3000	450	70	0.0001	99999

Maximum Permissible Error : In the lower zone from Qmin inclusive up to but excluding Qt is  $\pm 5\%$   
 In the upper zone from Qt inclusive up to and including Qs is  $\pm 2\%$

### FLOW ERROR CURVE

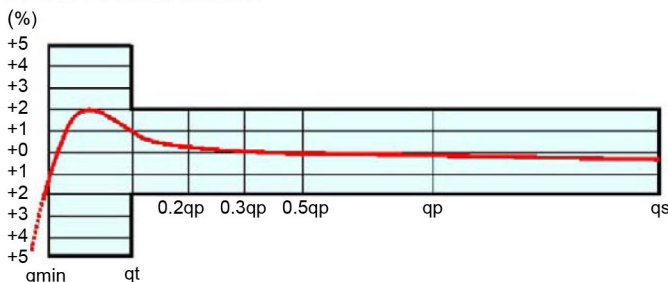

### HEAD PERMISSIBLE ERROR

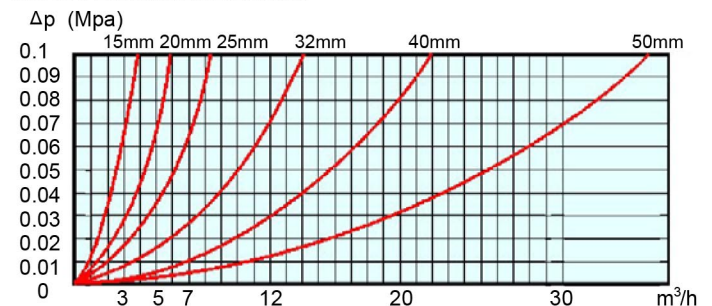

The contents of this literature are for informative purposes only. Arita is not responsible for suitability or compatibility of these products in relation to system requirement. For specific requirements, consult Arita or its distributors. Arita reserves the right to change or modify product design without prior notice.